

1  
10,000  
CONTEXT PLAN  
NTS

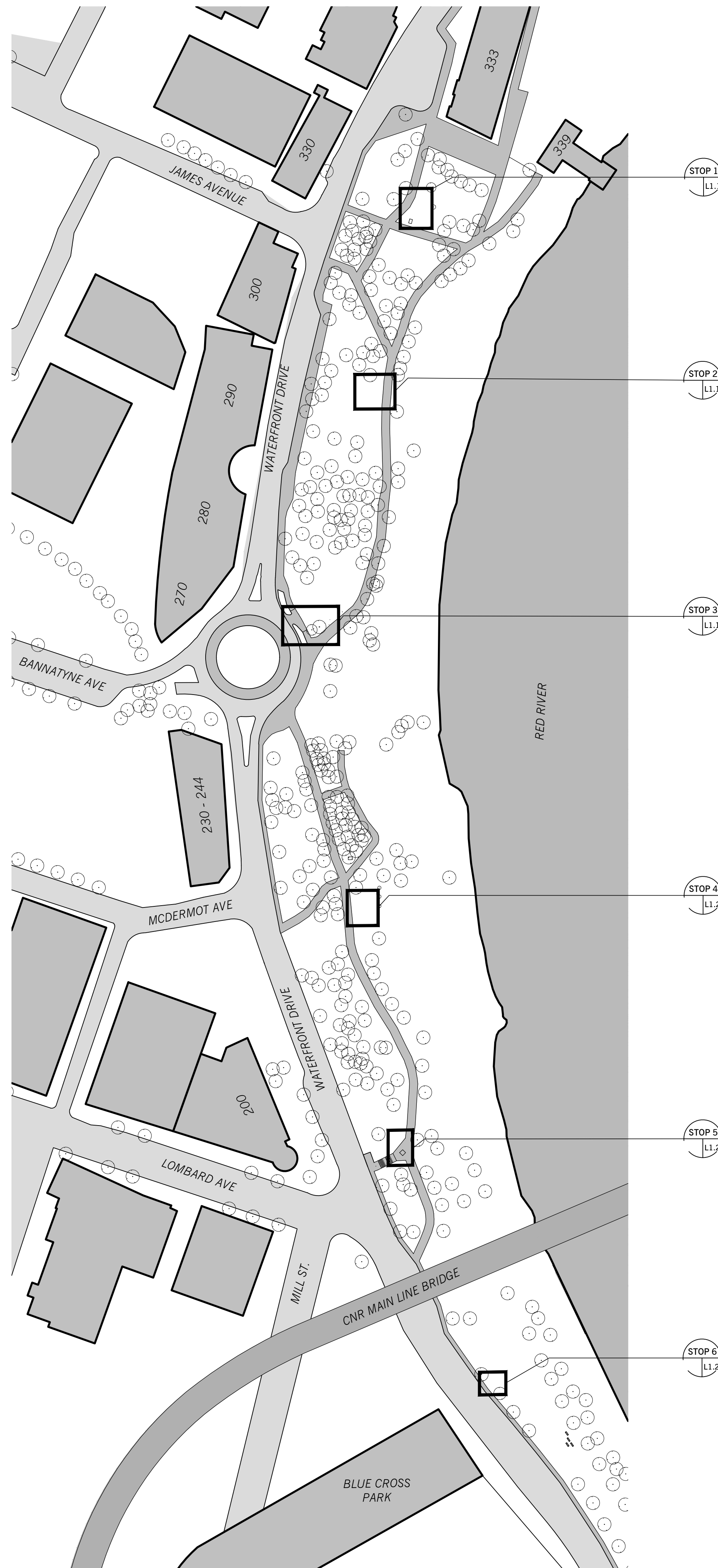

2  
10,000  
STOP LOCATIONS  
NTS

- NOTES**
- GENERAL LANDSCAPE:**
- DRAWINGS SHALL BE READ IN CONJUNCTION WITH SPECS.
  - ALL WORK SHALL BE PERFORMED IN ACCORDANCE WITH APPLICABLE CODES AND ORDINANCES AS ADOPTED BY THE LOCAL JURISDICTION HAVING AUTHORITY.
  - CONTRACTOR SHALL OBTAIN ALL NECESSARY PERMITS, PAY ALL NECESSARY FEES AND GIVE ALL NECESSARY NOTICES.
  - DO NOT SCALE DRAWINGS.
  - ALL DIMENSIONS ARE SHOWN IN METRIC (MM) UNLESS OTHERWISE NOTED.
  - REPORT ANY DISCREPANCIES WITH THE DRAWINGS AND UNEXPECTED CONDITIONS TO THE CONTRACTOR ADMINISTRATOR.
  - ALL TREES SHOWN ARE EXISTING AND THE LOCATIONS ARE APPROXIMATE. TREE INFORMATION OBTAINED FROM CITY OF WINNIPEG TREE INVENTORY OPEN DATA CATALOGUE (UPDATED MAY 2024). TREES DIRECTLY ADJACENT TO RIVER NOT SHOWN.
  - TREE PROTECTION METHODS TO ADHERE TO SECTION 3.19 OF THE CITY OF WINNIPEG PARK DESIGN STANDARDS VERSION 1.0 (OCTOBER 2023).
  - TREE PROTECTION ZONES ONLY NOTED ON TREES LOCATED NEAR FITNESS STOP CONSTRUCTION ZONES.
  - CONTOUR INFORMATION INTERPOLATED FROM CITY OF WINNIPEG MAP OF 2020 WWD LIDAR, FOR INFORMATION PROPOSES ONLY.
  - CONTRACTOR TO ENSURE THAT ALL UNDERGROUND UTILITIES ARE IDENTIFIED AND MARKED PRIOR TO EXCAVATION ACTIVITIES.
  - CONTRACTOR TO REPAIR ANY DAMAGE TO UNDERGROUND LINES CAUSED BY CONSTRUCTION ACTIVITIES INCLUDING BUT NOT LIMITED TO IRRIGATION AND UTILITIES.
  - INSTALL ALL MANUFACTURED ITEMS IN ACCORDANCE WITH MANUFACTURERS WRITTEN INSTRUCTIONS AND RECOMMENDATIONS.
  - INSTALL TEMPORARY CONSTRUCTION FENCING AROUND CONSTRUCTION AREAS.
  - SAW CUT ASPHALT AS REQUIRED TO CREATE UNIFORM EDGE ALONG CONCRETE PAD / TIMBER EDGING.
- DEMOLITION:**
- REFER TO LANDSCAPE SITE PLANS FOR EXTENT OF DEMOLITION. SOD REPLACEMENT TO EXTENT OF CONSTRUCTION LIMIT OR AS SHOWN.
  - CONSTRUCTION BOUNDARY FENCE TO BE INSTALLED PRIOR TO DEMOLITION AND CONSTRUCTION WORK.
  - SNOW FENCE BARRIERS AND SIGNAGE, IF SHOWN, TO BE INSTALLED TO PREVENT VEHICULAR ACCESS AND DAMAGE TO AREAS DESIGNATED FOR PROTECTION.
  - CONTRACTOR TO PROTECT ALL EXISTING ITEMS AND ENSURE THEY REMAIN AS PER SPECIFICATIONS AND AS NOTED ON DRAWINGS. AREAS DAMAGED DURING CONSTRUCTION NEED TO BE REPAIRED TO THE SATISFACTION OF THE CONTRACT ADMINISTRATOR AT THE CONTRACTORS COST.
  - ALL DISTURBED AREAS OUTSIDE THE CONSTRUCTION LIMIT AND PROPERTY LINE (INCLUDING LAYDOWN AREA) ARE TO BE RESTORED TO THEIR ORIGINAL CONDITION AT THE CONTRACTORS EXPENSE.
  - TREE PROTECTION METHOD TO REMAIN DURING ALL STAGES OF CONSTRUCTION. REFER TO SECTION 3.19 OF THE CITY OF WINNIPEG PARK DESIGN STANDARDS V.1 (OCT. 2023).
- LAYOUT:**
- UNLESS OTHERWISE NOTED, ALL DIMENSIONS PERTAINING TO TIMBER EDGING ARE TAKEN TO THE OUTSIDE FACE OF EDGING.
  - HARD SURFACES TO BE INSTALLED PRIOR TO SOFTSCAPING UNLESS OTHERWISE AUTHORIZED BY CONTRACT ADMINISTRATOR.
  - SAW CUT ASPHALT AS REQUIRED TO CREATE UNIFORM EDGE BETWEEN EXISTING ASPHALT PATHWAY AND TIMBER EDGING / CONCRETE PAD.
- GRADING:**
- CONTRACTOR TO SITE VERIFY EXISTING ELEVATIONS AND DIMENSIONS TO ENSURE THAT DESIGN INTENT CAN BE MET AS SHOWN. IF DISCREPANCIES ARISE, CONTRACTOR TO CONTACT CONTRACT ADMINISTRATOR IMMEDIATELY.
  - ENSURE POSITIVE DRAINAGE AWAY FROM TIMBER CRIBBING EDGING.
  - ALL SODDED AREAS TO BE SLOPED BETWEEN 1.5% AND 25%.

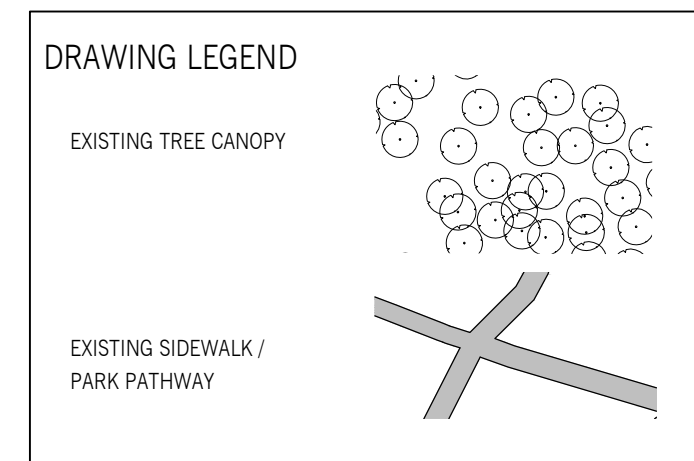

**DRAWING LIST**

LANDSCAPE	
LO.1	GENERAL NOTES & DRAWING LIST
L1.1	LANDSCAPE SITE PLANS STOPS 1 - 3
L1.2	LANDSCAPE SITE PLANS STOPS 4 - 6
L2.1	LANDSCAPE SITE DETAILS
L2.2	LANDSCAPE SITE DETAILS
CIVIL	
C1.1	SITE SERVICING PLAN

**PROPERTY INFORMATION**

ADDRESS:	65 BANNATYNE AVE
PROPERTY USE:	VACANT PARK
ADDRESS:	11 PIONEER AVE
PROPERTY USE:	VACANT PARK

- REFERENCE THE FOLLOWING CITY OF WINNIPEG CONSTRUCTION SPECIFICATIONS:**
- CW 3110 - R33 SUBGRADE, SUB-BASE AND BASE COURSE CONSTRUCTION
  - CW 3120 - INSTALLATION OF SUBDRAINS
  - CW 3130 - RS SUPPLY AND INSTALLATION OF GEOTEXTILE FABRICS
  - CW 3170 - EARTHWORK AND GRADING
  - CW 3325 - PORTLAND CEMENT CONCRETE SIDEWALK
  - CW 3510 - RIO SODDING
  - CW 3540 - TOPSOIL AND FINISH GRADING FOR ESTABLISHMENT OF TURF AREAS

Drawings and specifications, as instruments of service are the property of the architect. The copyright in the same being reserved to him. No reproduction may be made without the permission of the architect and when made, must bear his name. All prints to be returned to the architect. The contractor shall verify dimensions and data noted herein with conditions on the site and is held responsible for reporting any discrepancy to the architect for adjustment. This drawing shall not be used for building purposes until countersigned by:

SUBCONSULTANTS

PROFESSIONAL'S SEAL

ISSUE NO.	DATE	DESCRIPTION	BY
02	24 / 11 / 08	ISSUED FOR CONSTRUCTION	CA
01	24 / 09 / 05	ISSUED FOR 65% REVIEW	CA
00	YY / MM / DD	DESCRIPTION	BY

CONSULTANT FILE NAME
23692 STEPHEN JUBA PARK FITNESS TRAIL

**ft3**  
Architecture  
Landscape  
Interior Design

CITY OF WINNIPEG  
PLANNING & URBAN DESIGN DIVISION  
PLANNING, PROPERTY & DEVELOPMENT DEPARTMENT

**Winnipeg**

STEPHEN JUBA PARK FITNESS TRAIL

BD OPPORTUNITY NO.	971-2024	SHEET	1 OF 6
GENERAL NOTES & DRAWING LIST			
DESIGN	DRAWING	DATE - Y / M / D	LO.1
KS/BG	KS/BG	24 / 11 / 08	
CHECKED	APPROVED	PROJECT NO.	23.692
CA	CA		